

\$875,000 - 7520 408th Avenue Se, Snoqualmie

MLS® #2391307

\$875,000

2 Bedroom, 2 Bathroom, 1,620 sqft

Residential on 5.00 Acres

Indian Hill, Snoqualmie, WA

Soak in stunning Mount Si views from this 2 bedroom + office home on 5 serene acres. Ample room to roam, garden or expand. Vaulted ceilings and an open floor plan create airy, light-filled living, all on one level! Spacious kitchen with plenty of cabinets & counter space. Primary suite with walk-in closet and 5-piece bath. Modern upgrades include a Tesla battery wall (solar-ready!) and a 220 outlet at carport for EV charger. A detached 3-car garage; one-car garage and large workshop with power; and carport provide space for ALL of your tools, toys, and hobbies. Enjoy the peace of rural living with the convenience of nearby I-90 access and top-rated Snoqualmie Valley schools. A rare blend of lifestyle, functionality and natural beauty.

Built in 1995

Essential Information

MLS® #	2391307
List Price	\$875,000
Sale Price	\$850,000
Price Per SqFt	\$525
Bedrooms	2
Bathrooms	2
Full Baths	1
Square Footage	1,620
Acres	5.00

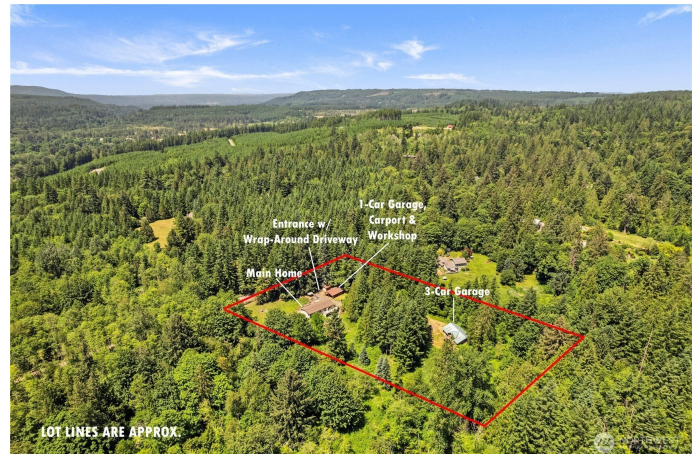

Year Built	1995
Type	Residential
Sub-Type	Manufactured On Land
Status	Sold

Community Information

Address	7520 408th Avenue Se
Area	540 - East of Lake Sammamish
Subdivision	Indian Hill
City	Snoqualmie
County	King
State	WA
Zip Code	98065

Amenities

Parking Spaces	5
Parking	Detached Carport, Driveway, Detached Garage, RV Parking
Garage Spaces	5

Interior

Interior Features	Bath Off Primary, Ceiling Fan(s), Double Pane/Storm Window, Dining Room, Fireplace, Vaulted Ceiling(s), Walk-In Closet(s), Water Heater
Appliances	Dishwasher(s), Disposal, Dryer(s), Microwave(s), Refrigerator(s), Stove(s)/Range(s), Washer(s)
Fireplace	Yes
# of Fireplaces	1
Fireplaces	Wood Burning

Exterior

Exterior Features	Wood Products
Lot Description	Adjacent to Public Land, Dirt Road, Open Space, Secluded, Value In Land
Foundation	Pillar/Post/Pier, Tie Down

School Information

District	Snoqualmie Valley
Elementary	Snoqualmie Elem
Middle	Snoqualmie Mid
High	Mount Si High

Additional Information

Days on Market	48
Cumulative Days on Market	48
Days on Website	39